

# FIA SCRUTINEERING PROCEDURES

## Pop-Off Valve for cars complying with Appendix J / article 261 – article 260E

Version	Publication date
V02	12.03.2026

### 1. APPLICABLE REGULATION

Rally2/R5 cars: Art. 261 of Appendix J.

Rally2 Kit/R4 Kit cars: Art. 260E of Appendix J.

In both cases, see the next:

- **Art. 304-2:**
- **FIA Technical list n°43 (Pop-off valve + insert)**

### 2. PARAMETER TO VERIFY

- Identification
- Opening pressure of FIA Homologated pop-off valve.
- Valve Stroke
- Airflow/port opening
- installation

### 3. PARTS AND MEASUREMENT DEVICES

FIA tube (see example of homologation form)

C11-9) Dessin du tube de contrôle de suralimentation FIA - déposé  
Drawing of FIA boost control pipe - dismounted

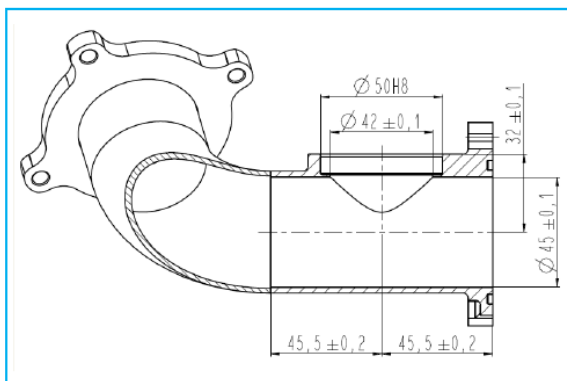

C11-10) Tube contrôle suralimentation FIA – Monté dans son emplacement  
FIA boost control pipe – Mounted in its location



Insert (see technical list N° 43)

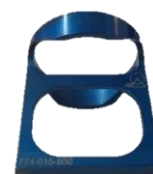

Pop-Off valve (see technical list N° 43) / **The Technical list may be updated**



FIA-R5-PopOff-008



FIA-R5-PopOff-009

**Checking equipment / example:**

Pop-Off valve device provided by Angle Consulting through the ASNs + tool for stroke



**4. PROCEDURE OF VERIFICATION AND ACCEPTANCE CRITERIA**

• **Identification:**

The pop-off is FIA homologated (see TL n°43 & identification sticker).

The Pop-Off valve must have an FIA sticker. FIA Stickers cannot be altered.

• **Installation**

Disassemble the Pop-Off valve and check that seal are in good condition and that the insert is correctly installed, as in the picture:

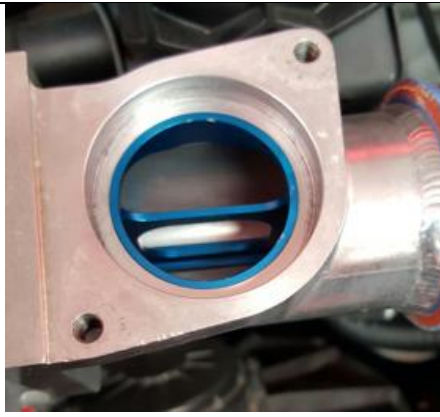

- Valve Stroke

1. Place the tool in the bottom part of the valve. During this test, the temperature of the pop-off body will need to be comprised between 5 and 30°C.
2. Introduce it through the holes and press it until the final of the stroke three times.



**Template must go until the end of the valve stroke.**

- Opening pressure of FIA Homologated pop-off valve.

1. Perform the Opening pressure test four (4) times. During this test, the temperature of the pop-off body will need to be comprised between 5 and 30°C.
2. Discard the first result.
3. Calculate the arithmetic average of the next three (3) results.

**Only valves whose average is below 1.65 bar relative will be accepted.**

- Airflow/port opening

During the pressure test, port must open and pressure must be released

## 5. CHECKING DURING AN EVENT

The following procedures should be followed during an event:

- **Pre-event Scrutineering:**
  1. The pop-off is FIA homologated (see TL n°43 & identification sticker).
  2. Identification
  3. Installation
  4. Valve Stroke
  5. Opening pressure of FIA Homologated pop-off valve.
  6. Finally, and only in the presence of a Scrutineer, the valve will be installed by the team, after installing the FIA insert for this purpose, and sealed by the Scrutineer.
  7. Maximum 2 pop-off valves will be checked at pre-event scrutineering unless agreed by the Technical Delegate.
  
- **Scrutineering during the event:**
  1. The pop-off valve may only be changed in Service Park and during Service time. The pop-off valve may not be changed outside Service Park. Tyre Fitting Zone is not considered as Service Park.
  2. The new pop-off valve and the old pop-off valve will be checked following the same procedure as pre-event scrutineering.
  3. The sealing of the pop-off may be checked at any time during the Event.
  
- **Final Scrutineering:**
  1. The valve may be dismantled only in the presence of a Scrutineer and after receiving the order from him/her.
  2. The opening pressure of FIA Homologated pop-off valve. pressure will then be measured without carrying out any other prior operation.
  3. Finally, the valve stroke will be controlled if requested by the Technical Delegate.

## 6. REMARKS

- Uncertainty of the pressure gauge, that must be properly verified in a laboratory, must be considered.
- Cooling of the Pop-Off valve: see article 261 & 260E => 900-a1 (cooling of auxiliaries).